

ANKER SOLIX

Anker SOLIX X1

Hybrid Energy Storage System



LinkedIn



Website



Email: support@anker.com

Phone: (UK) +44 (0) 1616 056 301 (DE) +49 (800) 000 2522

English

Anker at a Glance

Anker Innovations is a global leader in smart charging technology and a developer of consumer products for life at home, in the car, and on the go.

Since its founding in 2011, Anker products have sold to more than 140 countries and regions around the world, with more than 140 million users.

Join us as we create powerful and limitless possibilities.

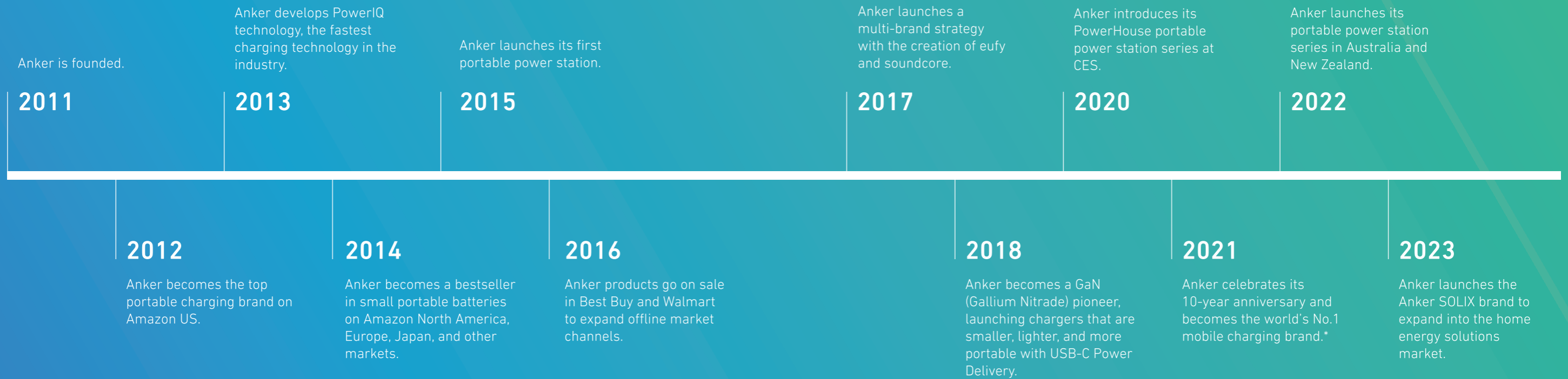

*Anker is the No. 1 mobile charging brand in the world in terms of the retail sales value in (3 consecutive years of) 2020, 2021, and 2022. Data source: Euromonitor Monitor International (Shanghai) Co., Ltd., measured in terms of retail value sales in 2020, 2021, and 2022, based on research conducted in October 2023. Mobile charging brands are defined as brands if more than 75% of their retail sales are contributed by mobile phone charging products. Mobile phone charging products include chargers, wireless chargers, power banks, and charging cables, and these accessories can also be used for other consumer electronics devices.

Brand Story

Electricity is the life force of our modern society, illuminating our homes and enriching our lives with technology. But this power behind our life is at risk due to the escalating environmental issues, marred by growing outages and surging instability. Even North America and Europe aren't immune to the issue.

At Anker, we've committed the last eight years to solving the problem with the goal of empowering our customers with energy independence. Now, we are ready to take another step forward.

Introducing Anker SOLIX, a consumer energy series offering reliable, intuitive, and sustainable power solutions for every household into the future.



Live in Power

eXtreme Series



Effortless Series



Flexible Series



Camping Series



Power for the Extreme



Reduce Utility Bills



24/7 Power Backup



Self-Consumption

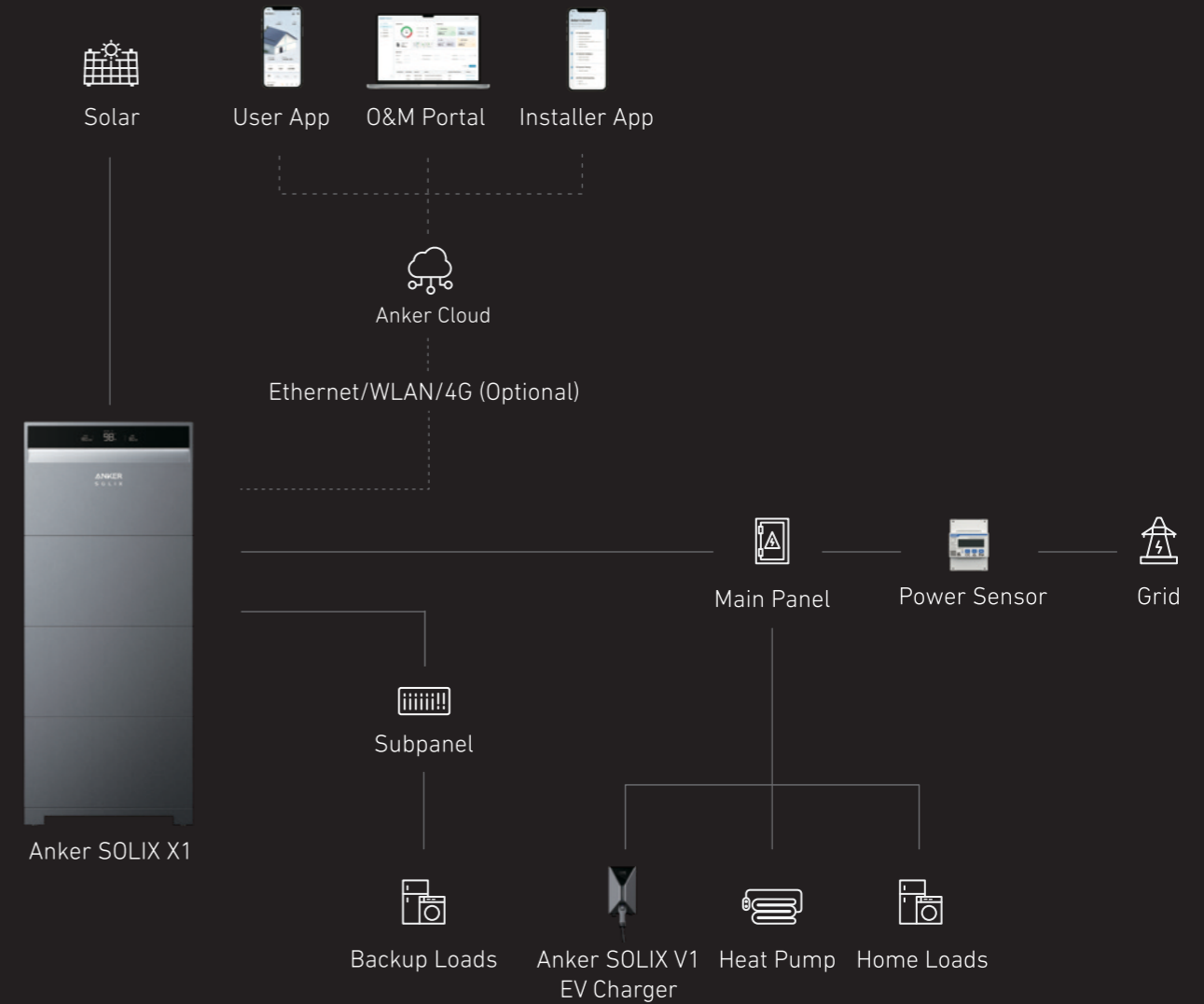

What Anker SOLIX Offers

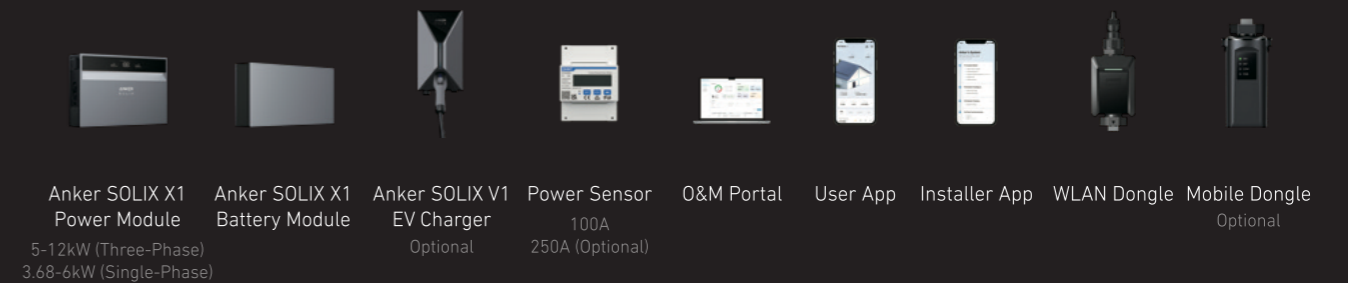

Notes:

1. The image of Hybrid Three-Phase Energy Storage System is for reference only. The actual product may differ upon release.
2. Images are for demonstration purposes only. Please refer to the Anker SOLIX website for product availability.
3. For WLAN, use the included WLAN dongle. It also supports an Ethernet connection.
4. 4G communication functions are available through Anker Mobile Dongle (optional).

All-in-One Design



Inspired by the Break of Dawn



Elegance for Any Home



15cm Ultra Thin



Starry Night Screen



2000 kWh+ More Power*

With Innovative Energy Optimizer

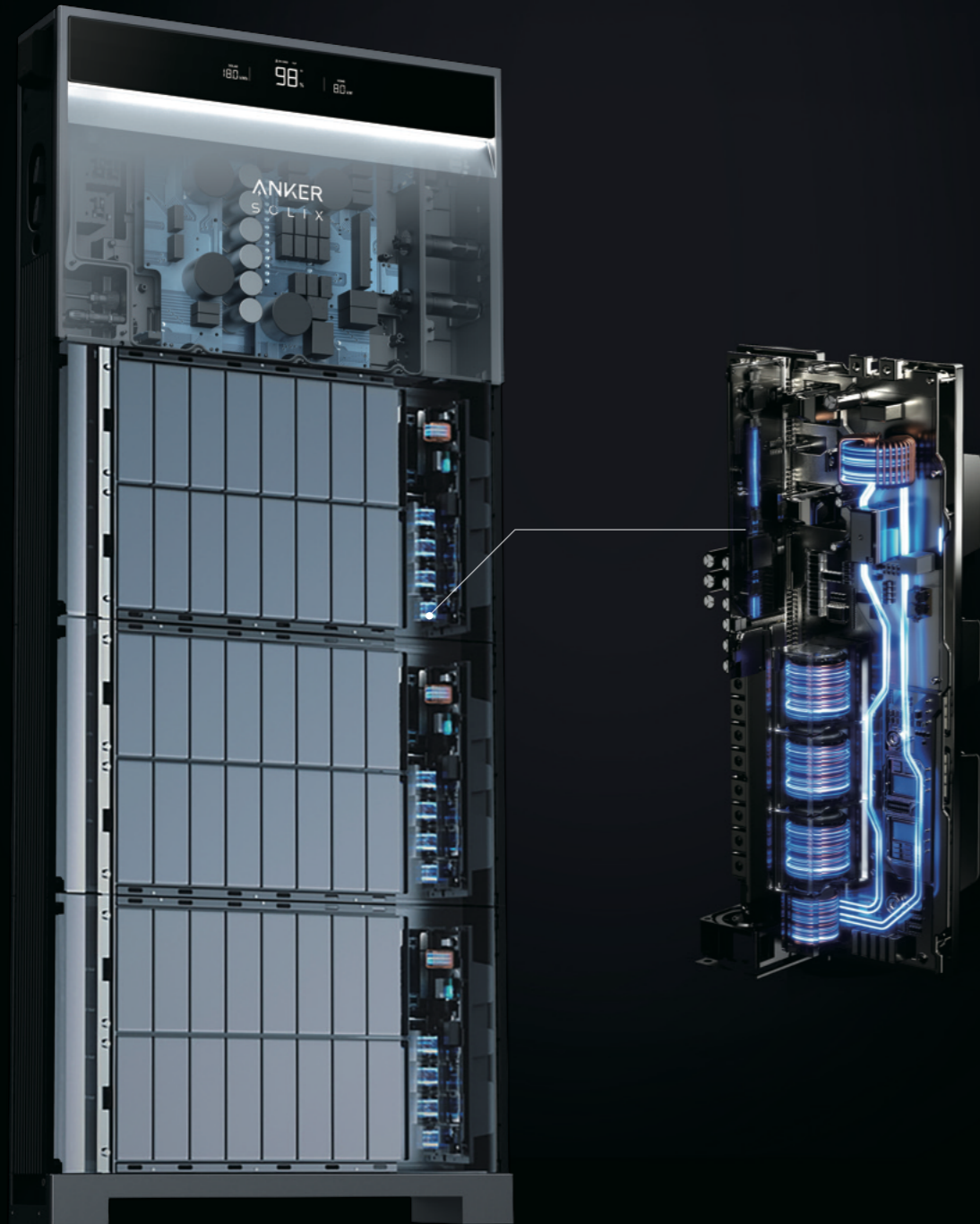

Make Your Home Self-Sufficient

Modular Design

5kWh-180kWh



Unites Your Home Energy



24/7 Whole-Home Backup

10ms UPS Switchover



Reliable System with 10-Year Warranty

Extreme Performance from
-20°C to 55°C



LFP Batteries



Auto-Isolation of Abnormal Batteries



0V Shutdown

IP66



Enjoy the Most User-Friendly Interface, the Anker App

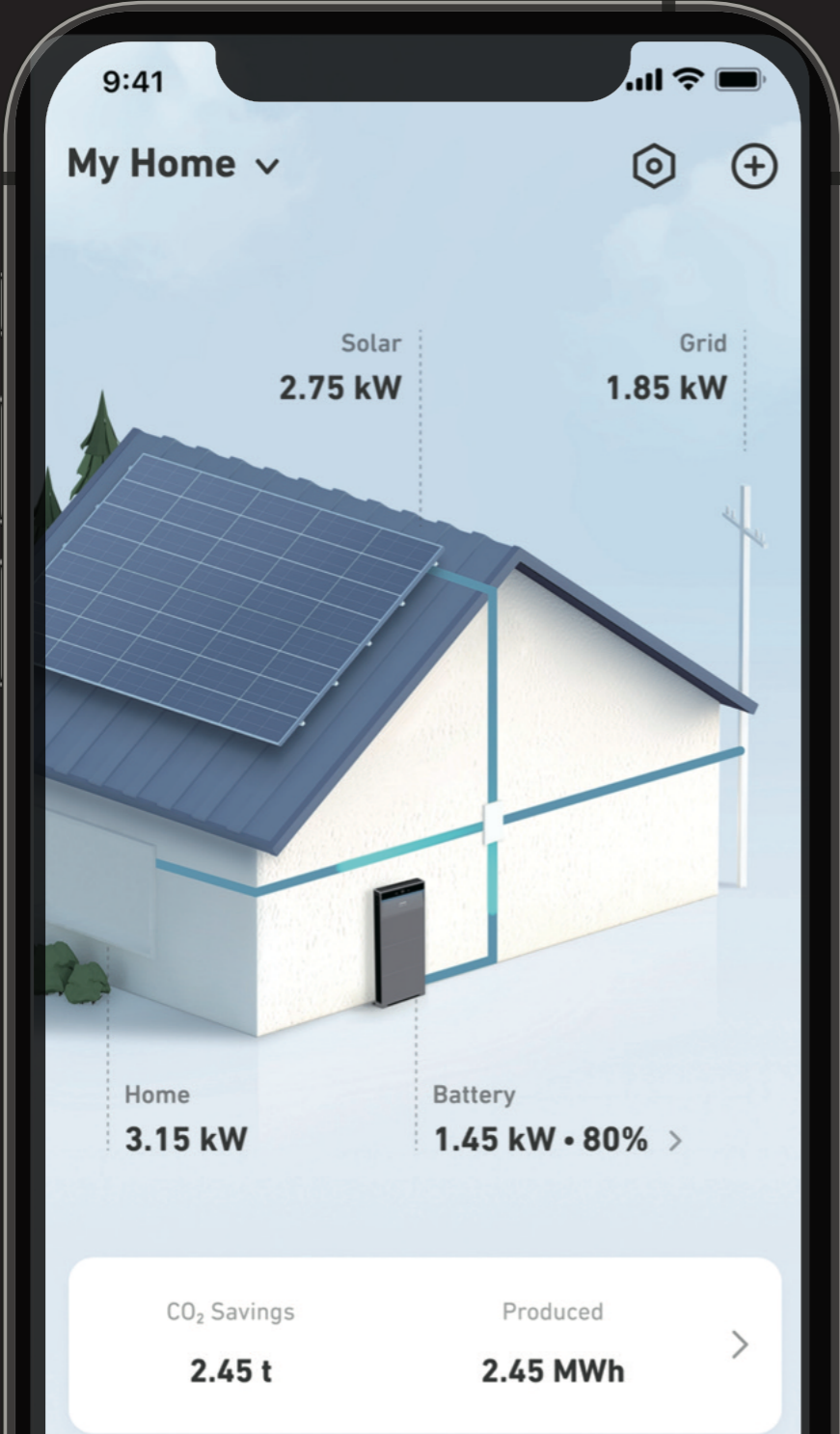

Intuitive User Experience

Anker SOLIX Professional O&M Portal



Anker App



Manage All Your Data



Summarize by History



Customized Data Viewing



Earnings at Your Fingertips



Power Module Hybrid Single-Phase Energy Storage System



Model	X1-H3.68K-S	X1-H4.6K-S	X1-H5K-S	X1-H6K-S
Battery Input				
Battery Type	LFP			
Charge Voltage Range	390 - 550 VDC			
Discharge Voltage Range	370 - 500 VDC			
Battery Capacity	5 - 30 kWh			
PV Input				
Max Input Power	7.36 kW	9.2 kW	10 kW	12 kW
Max Input Voltage	600 VDC			
MPPT Voltage Range	80 - 550 VDC			
Start-Up Voltage	75 VDC			
Rated Input Voltage	360 VDC			
Max Input Current	16 / 16 ADC			
Isc PV Array Short Circuit Current	20 / 20 ADC			
Number of MPPTs	2			
Number of Strings per MPPT	1			
AC Output (On-Grid)				
Rated Output Power	3.68 kW	4.6 kW	5 kW	6 kW
Max Output Apparent Power	4 kVA	5 kVA	5.5 kVA	6.6 kVA
Max Units in Parallel	3			
Rated Output Voltage	220 / 230 / 240 V			
Rated Frequency	50 / 60 Hz			
Power Factor	0.8 ind - 0.8 cap			
THDI (@Rated Power)	< 3%			
AC Output (Off-Grid)				
Rated Output Power	3.68 kW	4.6 kW	5 kW	6 kW
Max Output Apparent Power	4 kVA	5 kVA	5.5 kVA	6.6 kVA
Peak Output Apparent Power (Duration)	7.2 kVA (10s)	10 kVA (10s)	10 kVA (10s)	10 kVA (10s)
Max Units in Parallel	3			
Rated Output Voltage	220 / 230 / 240 VAC			
Rated Frequency	50 / 60 Hz			
THDU (@Linear Load)	< 2%			
Switch Time	<10 ms			
AC Input				
Max Input Apparent Power	7.2 kVA	10 kVA	10 kVA	10 kVA
Efficiency				
Max Efficiency	97.4%	97.5%	97.4%	97.6%
European Efficiency	96.5%	96.7%	96.7%	97.1%
Connectivity				
Internet Connectivity	Wi-Fi, Bluetooth, Ethernet, 4G (Optional)			
Other				
Weight	19 kg			
W×H×D Dimensions (mm)	670 × 335 × 150			
Noise	≤ 30 dB*			
Mounting Options	Ground or Wall**			
Operation Temperature	-25 °C to 60 °C***			
Relative Humidity	0 to 100%			
Max Operating Altitude	Up to 4,000 m, Power Derates from 2,000 m			
Ingress Protection Rating	IP66			
Warranty	10 Years Limited****			
Compliance Information (More Information Available Upon Request)				
Grid Connection Certifications	VDE-AR-N 4105, DIN VDE V 0124-100 (VDE V 0124-100), CEI 0-21, G99/1-9, C10/C11, NTS 2021 V2.1, UNE 2170021, UNE 217002, AS/NZS 4777.2			
Safety	EN IEC 62109-1, EN IEC 62109-2, AS 60947.3			
EMC	EN IEC 61000-6-1, EN IEC 61000-6-3			

Disclaimer: The product specifications and details contained in this brochure are based on preliminary information and are subject to change without notice. The actual product features and specifications may vary upon its official release.

*Tested in Anker laboratory at 1 m distance and typical scenarios.

**Additional rack required for wall mounting.

***Power derates once ambient temperature exceeds 45°C.

****Refer to Anker SOLIX X1 Home Energy Storage System Warranty Policy for details.

Power Module Hybrid Three-Phase Energy Storage System



Model	X1-H5K-T	X1-H8K-T	X1-H10K-T	X1-H12K-T
Battery Input				
Battery Type	LFP			
Voltage Range	350 - 450 VDC			
Battery Capacity	5 kWh - 30 kWh			
PV Input				
Max Input Power	10 kW	16 kW	20 kW	24 kW*
Max Input Voltage	1000 VDC			
MPPT Voltage Range	140 - 950 VDC			
Start-Up Voltage	160 VDC			
Rated Input Voltage	600 VDC			
Max Input Current	16 / 16 ADC			
Isc PV Array Short Circuit Current	20 / 20 ADC			
Number of MPPTs	2			
Number of Strings per MPPT	1			
AC Output (On-Grid)				
Rated Output Power	5 kW	8 kW	10 kW	12 kW
Max Output Apparent Power	5.5 kVA	8.8 kVA	11 kVA	13.2 kVA
Max Units in Parallel	6			
Rated Output Voltage	220/380 VAC, 230/400 VAC, 3L+N+PE			
Rated Frequency	50 / 60 Hz			
Power Factor	0.8 ind - 0.8 cap			
THDI (@Rated Power)	< 2%			
AC Output (Off-Grid)				
Rated Output Power	5 kW	8 kW	10 kW	12 kW
Max Output Apparent Power	5.25 kVA	8.4 kVA	10.5 kVA	12.6 kVA
Peak Output Apparent Power (Duration)	10 kVA (10s)	16 kVA (10s)	20 kVA (10s)	20 kVA (10s)
Max Units in Parallel	6			
Rated Output Voltage	220/380 VAC, 230/400 VAC, 3L+N+PE			
Rated Frequency	50 / 60 Hz			
THDU (@Linear Load)	< 2%			
Switch Time	< 10 ms (Typical)			
AC Input				
Max Input Apparent Power	20 kVA			
Efficiency				
Max Efficiency	97.9%	98.0%	98.0%	98.0%
European Efficiency	96.0%	97.1%	97.4%	97.5%
Connectivity				
Internet Connectivity	Wi-Fi, Bluetooth, Ethernet, 4G (Optional)			
Other				
Weight	30 kg			
W×H×D Dimensions (mm)	670 × 450 × 150			
Noise	≤ 30 dB**			
Mounting Options	Ground or Wall***			
Operation Temperature	-25 °C to 60 °C****			
Relative Humidity	0 to 100%			
Max Operating Altitude	Up to 4,000 m, Power Derates from 2,000 m			
Ingress Protection Rating	IP66			
Warranty	10 Years Limited*****			
Compliance Information (More Information Available Upon Request)				
Grid Connection Certifications	VDE-AR-N 4105, DIN VDE V 0124-100 (VDE V 0124-100), Austria OVE Directive R25 deviation based on VDE 4105, EN 50549-1 / 2, EIFS 2018:2, RfG, NC RfG, PTPIREE, C10/11, UNE 217002, PPDS: 2022, AS/NZS 4777.2			
Safety	EN IEC 62109-1, EN IEC 62109-2			
EMC	EN IEC 61000-6-1:2019, EN IEC 61000-6-3:2021, EN 62920:2017/A1:2021			

Disclaimer: The product specifications and details contained in this brochure are based on preliminary information and are subject to change without notice. The actual product features and specifications may vary upon its official release.

*Power derates once ambient temperature exceeds 35°C.

**Tested in Anker laboratory at 1 m distance and typical scenarios.

***Additional rack required for wall mounting.

****Power derates once ambient temperature exceeds 45°C.

*****Refer to Anker SOLIX X1 Home Energy Storage System Warranty Policy for details.

| Battery Module



Model	X1-B5-H
Performance Specifications	
Battery Energy*	5 kWh
Battery Type	Li-ion (LFP)
Battery Voltage Range	350 - 550 VDC
Maximum Charge / Discharge Power	3 kW
Maximum Charge / Discharge Current	7.6 A
Other	
W×H×D Dimensions (mm)	670 × 360 × 150
Weight	51 kg
Ingress Protection Rating	IP66
Operating Temperature	-20 °C to 55 °C
Maximum Operating Altitude	Up to 4,000 m, Power Derates from 2,000 m
Warranty	10 Years**
Compliance Information	
Certifications	IEC 62619, IEC 62040-1, VDE-AR-E 2510-50, UN38.3

*The initial capacity (design capacity) of an expansion battery is 5 kWh. The actual capacity may vary depending on environmental conditions, such as temperature, transportation methods, and storage conditions.
 **Refer to Anker SOLIX X1 Home Energy Storage System Warranty Policy for details.

| System Parameters Hybrid Single-Phase Energy Storage System



Battery Modules	1	2	3	4**	5**	6**
Energy Capacity	5 kWh	10 kWh	15 kWh	20 kWh	25 kWh	30 kWh
Weight*	73.5 kg	124.5 kg	175.5 kg	232 kg	283 kg	334 kg
W×H×D Dimensions (mm)**	670 × 765 × 150	670 × 1,125 × 150	670 × 1,485 × 150	670 × 1,485 × 150 670 × 482 × 150	670 × 1,485 × 150 670 × 842 × 150	670 × 1,485 × 150 670 × 1,202 × 150

*Includes floor mounting base and top cover.
 **Two column installation.

| System Parameters Hybrid Three-Phase Energy Storage System



Battery Modules	1	2	3	4**	5**	6**
Energy Capacity	5 kWh	10 kWh	15 kWh	20 kWh	25 kWh	30 kWh
Weight*	84.5 kg	135.5 kg	186.5 kg	243 kg	294 kg	345 kg
W×H×D Dimensions (mm)**	670 × 880 × 150	670 × 1,240 × 150	670 × 1,600 × 150	670 × 1,600 × 150 670 × 482 × 150	670 × 1,600 × 150 670 × 842 × 150	670 × 1,600 × 150 670 × 1,202 × 150

*Includes floor mounting base and top cover.
 **Two column installation.

| Power Sensor



Model	DTSU666	DDSU666
Power Supply		
Grid Connection Type	3P4W	1P2W
Frequency	50 / 60 Hz	
Nominal Voltage	3× 220 / 380 V - 3× 240 / 415 V	220 - 240 V
Measurement Range		
Current Range	0 - 100 A	0 - 250 A
Voltage Range	3× 57.7 / 100 V - 3× 288 / 500 V	100 - 276 V
Accuracy		
Voltage Accuracy	Class B (Class 1)	
Current Accuracy	Class B (Class 1)	
Power Accuracy	Class B (Class 1)	
Frequency Accuracy	Class B (Class 1)	
General Specifications		
H×W×D Dimensions (mm)	100 × 72 × 65.5	100 × 36 × 65.5
Weight	0.3 kg	0.18 kg
Storage Temperature Range	-40 °C to 70 °C	
Operating Temperature Range	-25 °C to 55 °C	
Relative Humidity Range	0 to 95%	
Ingress Protection Rating	IP51	
Installation Method	DIN Rail 35 mm	
Communication		
Interface	RS485	
Baud Rate	1200/2400/4800/9600/19200/38400/115200 bps	1200/2400/4800/9600/ 19200/115200 bps
Protocol	Modbus RTU	
Other		
Accessories	3 CT 100 A / 40 mA (6 m)	3 CT 250 A / 50 mA (6 m)

| WLAN Dongle

Model	DG-WF-H
Standard	2.4 GHz 802.11b/g/n Compatibility
Security	802.11i (WPA, WPA2)
Data Rate	Up to 150 Mbps (Theoretical Value)
TX Power	17 dBm @ CCK, 16.5 dBm @ OFDM, 16.5 dBm @ MCS
Sensitivity	-88 dBm @ CCK, -75 dBm @ OFDM, -69 dBm @ MCS
Ethernet	
Standard	IEEE 802.3 for 10BaseT, IEEE 802.3u for 100BaseTX
Speed	10/100 Mbps, Auto MDI/MDIX
Bluetooth	
Standard	Bluetooth v4.2 BLE
Range	10 m
Speed	1 Mbps (Theoretical Value)
Interface	
RS-485	1 Port
Input Voltage	8 VDC
Environment	
Operating Temperature	-40 °C to 70 °C
Storage Temperature	-40 °C to 85 °C
Humidity	5% to 95% Non-Condensing
Connector	
Pin 1	V+
Pin 2	RS-485 B (D-)
Pin 3	RS-485 A (D+)
Pin 4	GND
Mechanical Specifications	
Dimensions	102 × 50 × 35 mm
Ingress Protection Rating	IP65

| Mobile Dongle

Model	VD-606L8-WB-AK
Cellular Networks	
Frequencies	LTE UE-Cat.4, LTE FDD: B1/B3/B5/B7/B8/B20/B28, LTE TDD: B38/B40/B41, WCDMA: B1/B5/B8, GSM: 900/1800 MHz
Speed	Max 150Mbps (DL), Max 50Mbps (UL)
Antenna	Built-in, LDS, Gain: 3.87 dBi
TX Power	19dBm ± 2dB
Sensitivity	-92dBm ± 2dB at FDD of 10 m
Bluetooth	
Standard	Bluetooth v4.2 BLE Specification
Operational Range	Max 30 m (Theoretical Value)
Speed	1Mbps (Theoretical Value)
Interface	
RS-485	1
Power	Input Voltage: 5 - 12 VDC, Consumption: 4.5 W
Environment	
Operating Temperature	-40 °C to 70 °C
Storage Temperature	-40 °C to 85 °C
Humidity	5% to 95% Non-Condensing
LED Indicators	
Power	Off: Powered Off, On: Power Supplied from DC Input
Network	Off: Powered Off, On: Connected to Internet, Flashing: Disconnected from Internet
Mechanical	
W×H×D Dimensions (mm)	107 × 49 × 36.8
Case Material	Plastic
Ingress Protection Rating	IP65
Warranty	
Dongle Warranty	5 Years*

*Refer to Anker SOLIX X1 Home Energy Storage System Warranty Policy for details.

| Anker (User App)

App Features	
Operating System	Android and iOS
Rapid Battery Charging	Yes
SOC Setting	0 - 100%
Power Sources Monitor	Working Status, Power Flow
Historical Data	Daily, Weekly, Monthly, Yearly
Grid Charging	Yes
Account Security	Password Verification Support
EMS Modes	Self-Consumption
	Time of Use
EV Charger	Rapid Battery Charging
	Green Electricity Charging, Fast Charging, Smart Charging
Heat Pump	Manual Mode, Automatic Mode, Smart Mode

| Anker SOLIX Professional (Installer App)

App Features		
Power Site Management	Power Site Lists	Search / System ID / Device Location / System Name Add System / Delete System
	System Build	Collect Owner Details Search Device (Via Bluetooth) Configure System Network
System Configuration	Select Grid Code	Location Map Self-Search / Scan Code to Connect Multiple Network Connections
	Meter and DI/DO Configuration (For EU Hardware)	Grid Parameters Meter and DI/DO Configuration
System Testing	Power On System	Power On Communication Fault Detection Ground Fault Detection
	Wiring Inspection	CT Self-Adaption
	CT Connection Detection	On-Grid Functional Testing Off-Grid Functional Testing
	On-Grid and Off-Grid Functional Testing	Validation Code / Enter Email Heat Pumps and Generators
Post Commissioning	Delivery	
	External Device Configuration	

| Anker SOLIX Professional (O&M Portal)

Web Features		
Intelligent Monitoring	System List	System Status System Data Battery Installation Data Map System List Display
		System Map
System Monitoring	System Monitoring	Search Map Basic Data System Monitor Entry System Overview EV Charger Energy Statistics Device Details Fault Information Advanced Parameter Settings
		Fault Management
System Management	User Management and Permission Allocation	Fault List Fault Push Configuration Fault Push Information User Management Role Type Management Role Management Organization Management

Anker in Europe 2024

In Europe, For Europe



50+ Employees

4 Offices (4 More Planned)

11 Warehouses



Local Sales Team



Local Warehouses



Local Service Team



Local Call Center

ANKER SOLIX